

FIST In-Line Closure for Modular Cable**TELECOM OUTSIDE PLANT**

FIST is Tyco's Fiber Infrastructure System Technology, originally developed to accommodate standard fiber optic cables, and now extended with a new range of similar products to handle modular cables and blown microcables.

The generic closure FIST-GCO2 is an environmentally sealed enclosure for a fiber management system that provides the functions of splice and passive component integration into the external network.

The FIST-GCO2 for modular cables has the following functions and features:

- Single-ended design
- Base and dome are sealed with a clamp and O-ring system
- 6/16 round entry/exit ports for drop cables and 1 oval port for looped cable
- The UMS (Universal Mounting System) profiles provide the foundation for mounting combinations of SOSA2 (Splice Only Sub-Assembly) and/or SASA2 (Splitter Array Sub-Assembly) modules, which consist of a modular groove plate and trays
- Specially configured to be used with modular cables (raised frame position)
- Uncut fibers can be stored as single circuits in trays and/or as cable elements in the storage space between the profiles.

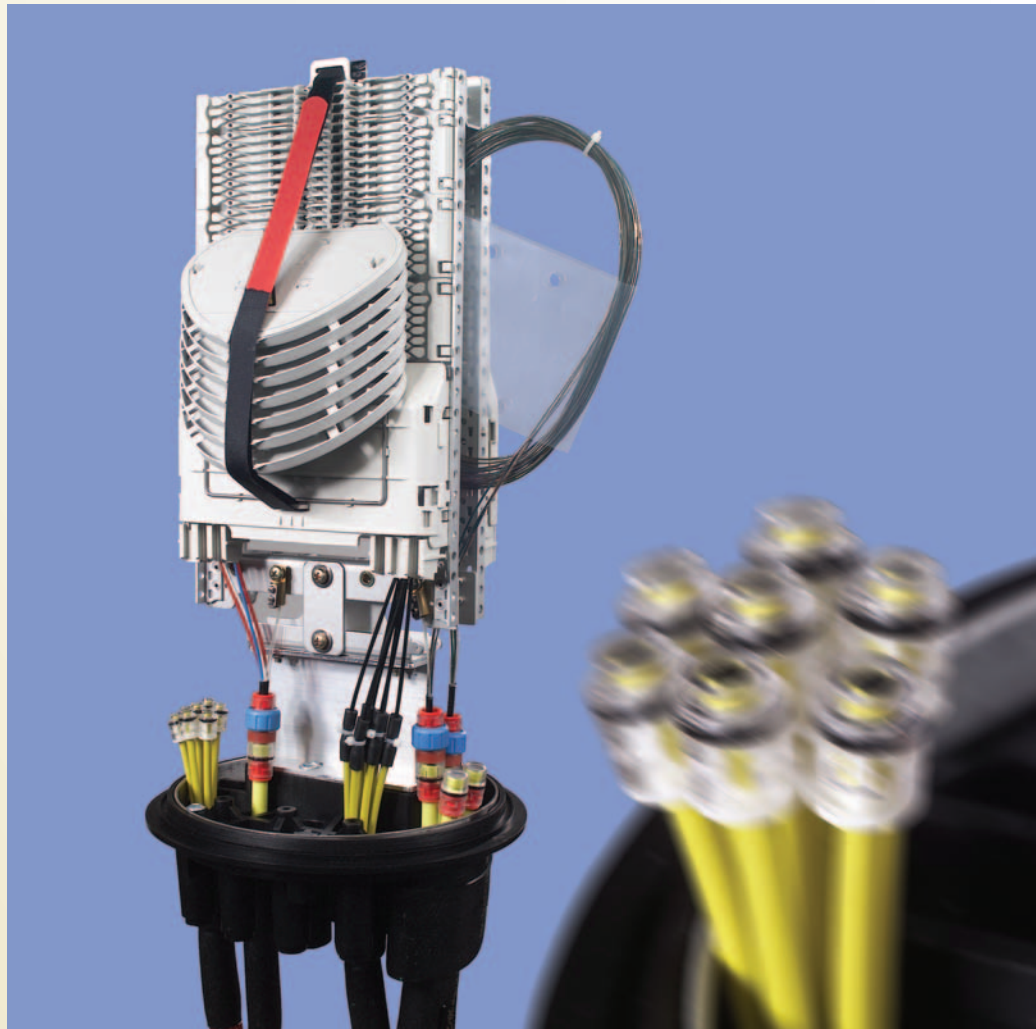
**FIST-GCO2-MC**

FIST-GCO2-MC

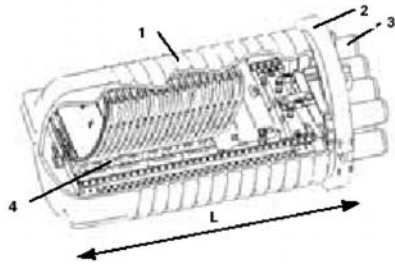

Key

- 1 Dome
- 2 Clamp
- 3 Base
- 4 Wrap-around groove plates

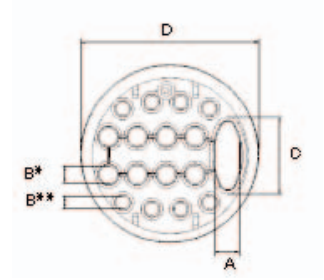
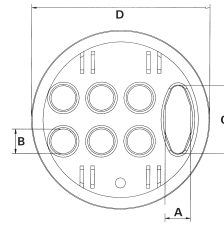

Dimensions and capacities

Dimensions in mm	GCO2-BC6/16	GCO2-BD6/16	GCO2-BE6/16
L	488	566	700
A	30	30	30
B/B*/B**	30/20/13.5	30/20/13.5	30/20/13.5
C	82	82	82
D	247	247	247
D with clamp	285	285	285
UMS units	14	28	42

	Fibers	Trays	Fibers	Trays	Fibers	Trays
Single circuit splicing capacity	48	24	112	56	160	80
Single element splicing capacity	144	12	336	28	480	40

Ordering information

FIST-GCO2 - XX X - MC - X X

Closure TYPE

- BC** 488 mm long with two 12-units UMS
- BD** 555 mm long with two 28-units UMS
- BE** 700 mm long with two 40-units UMS

Number of round ports

- 16** 8 ports with max.cable Ø 13.5 mm (1)
8 ports with max.cable Ø 20 mm (2)
- 6** 6 ports with max.cable Ø 30 mm (3)

Flash test point

- V** Pre-mounted flash test point in dome

Ground feed-through

- G** Pre-mounted ground feed-through
- N** No ground feed-through

Typical multi-duct capacities (will vary depending upon the supplier's specifications):

- (1) 1W5mm or 2W5mm.
- (2) 1W10mm, 1W5mm, or 2W5mm/4W5mm/7W5mm.
- (3) 1W10mm/2W10mm/4W10mm or 1W5mm/2W5mm/4W5mm/7W5mm/12W5mm.

For a list of accessories, please refer to the FIST-GCO2-MC Ordering Guide.

Tyco Electronics Raychem NV

Telecom Outside Plant

Diestsesteenweg 692
3010 Kessele-Lo, Belgium
Tel.: 32-16 351 011
Fax: 32-16 351 697
www.tycoelectronics.com
www.telecomosp.com

Tyco Electronics Corporation

Telecom Outside Plant

8000 Purfoy Road
Fuquay Varina - NC 27526-9349
Tel.: 1-919-557-8900
Fax: 1-919-557-8598

Tyco and FIST are trademarks

The information given herein, including drawings, illustrations and schematics which are intended for illustration purposes only, is believed to be reliable. However, Tyco Electronics makes no warranties as to its accuracy or completeness and disclaims any liability in connection with its use. Tyco Electronics' obligations shall only be as set forth in Tyco Electronics' Standard Terms and Conditions of Sale for this product and in no case will Tyco Electronics be liable for any incidental, indirect or consequential damages arising out of the sale, resale, use or misuse of the product. Users of Tyco Electronics products should make their own evaluation to determine the suitability of each such product for the specific application.